



**NOAH THOMAS**  
ASSOCIATE

[nthomas@cmprealestategroup.com](mailto:nthomas@cmprealestategroup.com)

**ANTHONY SESI**  
VICE PRESIDENT

[asesi@cmprealestategroup.com](mailto:asesi@cmprealestategroup.com)

6476 Orchard Lake Road | Suite A | West Bloomfield | Michigan | 48322

Phone: 248.538.2000 | [www.cmprealestategroup.com](http://www.cmprealestategroup.com)

### PROPERTY INFORMATION

Property Address	1537-1585 N Wixom Road
City/Township	Wixom
Building Size	31,645 SF
Land Size	3.63 AC
Space Available	18,080 SF
Minimum Available	1,500 SF
Maximum Available	10,880 SF
Asking Rental Rate	\$14.00 PSF

### DEMOGRAPHICS (FIVE-MILE RADIUS)



**POPULATION**  
102,319 PEOPLE



**MEDIAN AGE**  
40.9 YEARS OLD



**HOUSEHOLDS**  
41,660



**CONSUMER SPENDING**  
\$1.4 BILLION ANNUALLY



**AVG HOUSEHOLD INCOME**  
\$108,593/ANNUALLY



**DAYTIME EMPLOYEES**  
54,162 EMPLOYEES

### JOIN



H&R BLOCK



### AREA TENANTS & EMPLOYERS



### PROPERTY HIGHLIGHTS

- Retail space available at Wixom and Charms.
- Wixom Road sees about 15,000 cars daily.
- New residential development built just North of center on Wixom Road.
- Just 1.5 miles from downtown Wixom and less than 3 miles from I-96.
- Available space is optimal for retail, office, or service use.



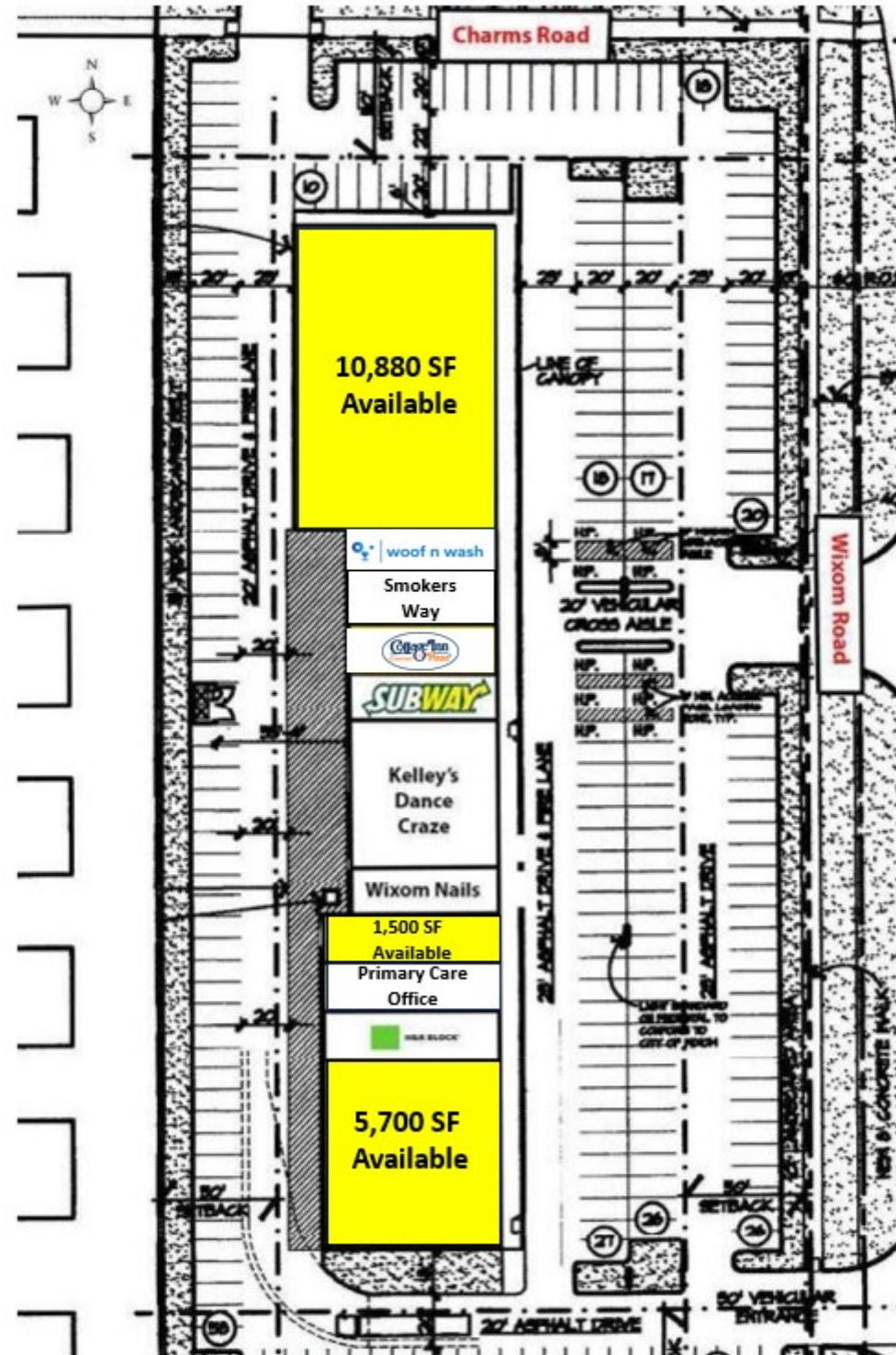



A cluster of four business logos: Dollar Tree (green tree icon), Marathon (red 'M' in a blue hexagon), Marco's Pizza (red pizza icon), and Saroki's (red rooster icon).

Sarah Banks Middle School

SITE

Twin Sun Early Childhood Center

Loon Lake Elementary School

POPULATION	1 MILE	3 MILE	5 MILE
2010 Population	7,657	35,666	86,680
2023 Population	8,933	41,437	102,319
2028 Population Projection	9,153	42,431	105,029
Annual Growth 2010-2022	1.30%	1.20%	1.40%
Annual Growth 2023-2027	0.50%	0.50%	0.50%
Median Age	39.6	39.3	40.9
Bachelor's Degree or Higher	37%	38%	44%

POPULATION BY RACE	1 MILE	3 MILE	5 MILE
White	8,035	34,333	84,753
Black	137	3,429	6,350
American Indian/Alaskan Native	32	149	344
Asian	531	2,548	8,608
Hawaiian & Pacific Islander	0	12	16
Two or More Races	198	965	2,247
Hispanic Origin	453	2,623	4,952

HOUSEHOLDS	1 MILE	3 MILE	5 MILE
2010 Households	2,690	14,988	35,090
2023 Households	3,102	17,449	41,660
2028 Household Projection	3,172	17,874	42,801
Owner Occupied Households	2,896	10,551	30,091
Renter Occupied Households	277	7,323	12,710
<b>Avg Household Income</b>	<b>\$119,192</b>	<b>\$95,976</b>	<b>\$108,593</b>
<b>Median Household Income</b>	<b>\$99,188</b>	<b>\$72,323</b>	<b>\$83,268</b>

INCOME	1 MILE	3 MILE	5 MILE
\$25,000 - 50,000	529	3,642	7,363
\$50,000 - 75,000	346	2,763	6,511
\$75,000 - 100,000	416	2,335	5,299
\$100,000 - 125,000	389	1,930	4,544
\$125,000 - 150,000	438	1,311	3,223
\$150,000 - 200,000	277	1,238	4,509
\$200,000+	433	1,617	5,008

DAYTIME EMPLOYMENT	ONE MILE			THREE MILE			FIVE MILE		
	TOTAL EMPLOYEES	TOTAL BUSINESSES	EMPLOYEES PER BUSINESS	TOTAL EMPLOYEES	TOTAL BUSINESSES	EMPLOYEES PER BUSINESS	TOTAL EMPLOYEES	TOTAL BUSINESSES	EMPLOYEES PER BUSINESS
<b>Service-Producing Industries</b>	<b>382</b>	<b>64</b>	<b>6</b>	<b>10,562</b>	<b>1,093</b>	<b>10</b>	<b>42,403</b>	<b>4,393</b>	<b>10</b>
Trade Transportation & Utilities	58	9	6	3,009	245	12	13,739	835	16
Information	6	1	6	624	43	15	1,494	105	14
Financial Activities	15	5	3	707	135	5	2,493	468	5
Professional & Business Services	60	14	4	2,228	243	9	6,377	711	9
Education & Health Services	98	11	9	1,927	177	11	9,625	1,457	7
Leisure & Hospitality	65	8	8	1,154	103	11	5,607	386	15
Other Services	34	12	3	720	126	6	2,400	371	6
Public Administration	46	4	12	193	21	9	668	60	11
<b>Goods-Producing Industries</b>	<b>34</b>	<b>12</b>	<b>3</b>	<b>6,774</b>	<b>319</b>	<b>21</b>	<b>11,759</b>	<b>706</b>	<b>17</b>
Natural Resources & Mining	0	0	-	26	3	9	41	8	5
Construction	28	10	3	1,739	148	12	3,169	354	9
Manufacturing	6	2	3	5,009	168	30	8,549	344	25
<b>Total</b>	<b>416</b>	<b>76</b>	<b>5</b>	<b>17,336</b>	<b>1,412</b>	<b>12</b>	<b>54,162</b>	<b>5,099</b>	<b>11</b>

## EXCLUSIVELY LISTED BY:

**NOAH THOMAS**  
ASSOCIATE

[nthomas@cmprealestategroup.com](mailto:nthomas@cmprealestategroup.com)

**ANTHONY SESI**  
VICE PRESIDENT

[asesi@cmprealestategroup.com](mailto:asesi@cmprealestategroup.com)

## CONTACT US:



6476 Orchard Lake Road, Suite A  
West Bloomfield, Michigan 48322



(P): 248.538.2000  
(F): 248.538.9905



Email: [info@cmprealestategroup.com](mailto:info@cmprealestategroup.com)  
Website: [www.cmprealestategroup.com](http://www.cmprealestategroup.com)

The information contained in this Marketing Package does not purport to provide a complete or fully accurate summary of the Property or any of the documents related thereto, nor does it purport to all inclusive or to contain all the information, which a potential tenant may need or desire. All information contained herein has been secured by sources we believe to be reliable; however, CMP Real Estate Group, LLC ("Broker") has not independently verified any of the information. This Marketing Package prepared by Broker, does not constitute an indication that there has been no change in the Property or the market conditions since the date of preparation of the information herein. Additional information and an opportunity to inspect the Property will be made available to the interested and qualified prospective tenant/purchaser, if available.

Neither Owner nor Broker nor any of there respective officers, Agents or principals has made or will make any representations or warranties, express or implied, as to the accuracy or completeness of this Marketing Package or any of its contents, and no legal commitment or obligation shall arise by reason of the Marketing Package or its contents. Analysis and verification of the information contained in the Marketing Package is solely the responsibility of the prospective tenant/purchaser.

Owner and Broker expressly reserve the right, at their sole discretion, to reject any or all expressions of interest or offers to lease/purchase the Property and/or terminate discussions with any entity at anytime with or without notice. Owner has no legal commitment or obligation to any entity reviewing this Marketing Package or making an offer to lease/purchase the Property unless and until such lease/sale of the Property is approved by Owner in its sole discretion, a written agreement for lease/purchase of the Property unless and until such sale of the Property is approved by Owner in its sole discretion, a written agreement for leased/purchase of the Property has been fully delivered, and approve by Owner, its legal counsel and any conditions to the Owner's obligations thereunder have been satisfied or waived.



**RETAIL LEASING**  
*Landlord Representation  
& New Project Leasing*



**TENANT REPRESENTATION**  
*Site Selection &  
Negotiations*



**INVESTMENT SALES**  
*STNL & Multi-Tenant, Multi-  
Family, Carwashes, etc.*



**ACQUISITIONS/DISPOSITIONS**  
*Single & Full Portfolio  
Transactions*



**MARKET ANALYSIS**  
*Market Research  
& Site Evaluations*



**NATIONAL RELATIONSHIPS**  
*Retailers & Investors  
across the U.S.*



**TEAMWORK**  
*Innovative  
Solutions*



**SHARED DATABASE**  
*Retailers & Investors  
across the U.S.*