



**LANCE NUMAN**  
ASSOCIATE

**CHRIS JONNA**  
PRESIDENT

[lnuman@cmpraestategroup.com](mailto:lnuman@cmpraestategroup.com)

[cjonna@cmpraestategroup.com](mailto:cjonna@cmpraestategroup.com)

6476 Orchard Lake Road | Suite A | West Bloomfield | Michigan | 48322

Phone: 248.538.2000 | [www.cmpraestategroup.com](http://www.cmpraestategroup.com)

### PROPERTY INFORMATION

Property Address	32395-32443 Northwestern Highway
City/Township	Farmington Hills
Shopping Center Size	15,000 SF
Space Available	3,200 SF
Minimum Available	1,600 SF
Maximum Available	3,200 SF
Asking Rental Rate	\$21.00 PSF
Estimated NNN's	\$6.50 PSF

### DEMOGRAPHICS (FIVE-MILE RADIUS)

 <b>POPULATION</b> 806,691 PEOPLE	 <b>MEDIAN AGE</b> 42.2 YEARS OLD
 <b>HOUSEHOLDS</b> 331,963	 <b>CONSUMER SPENDING</b> \$11 BILLION ANNUALLY
 <b>AVG HOUSEHOLD INCOME</b> \$104,516/ANNUALLY	 <b>DAYTIME EMPLOYEES</b> 463,755 EMPLOYEES

### JOIN



### AREA TENANTS & EMPLOYERS



### PROPERTY HIGHLIGHTS

- Join Community Clinic at Walgreens, Siam Spicy II and many more at Tri-Atria Center.
- This shopping center has great visibility with strong traffic counts and situated in front of Home Depot in a large office district.
- Site is located on the South side of busy Northwestern Highway between Middlebelt and 14 Mile Roads.



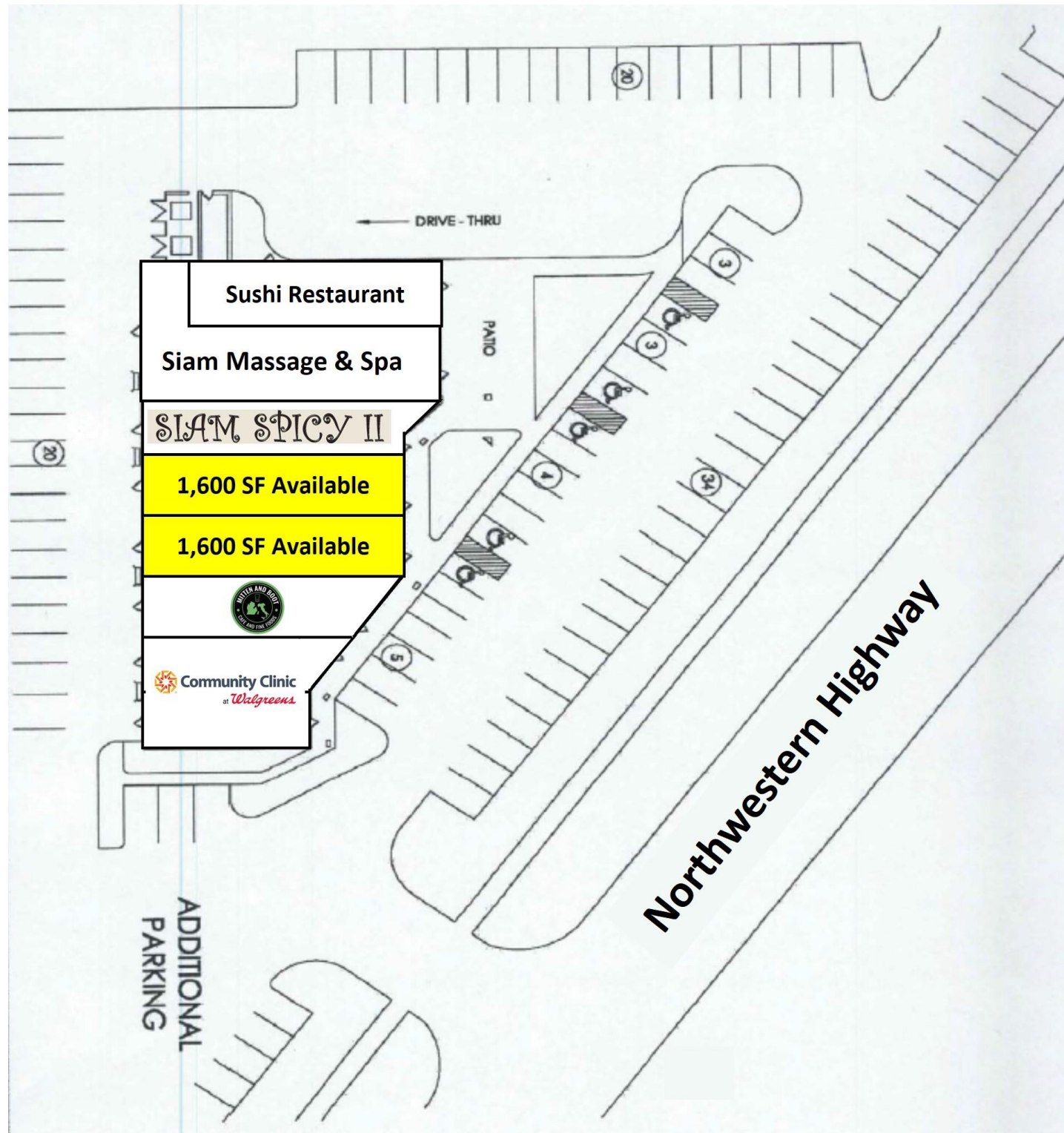

# TRI ATRIA SHOPPING CENTER

AERIAL

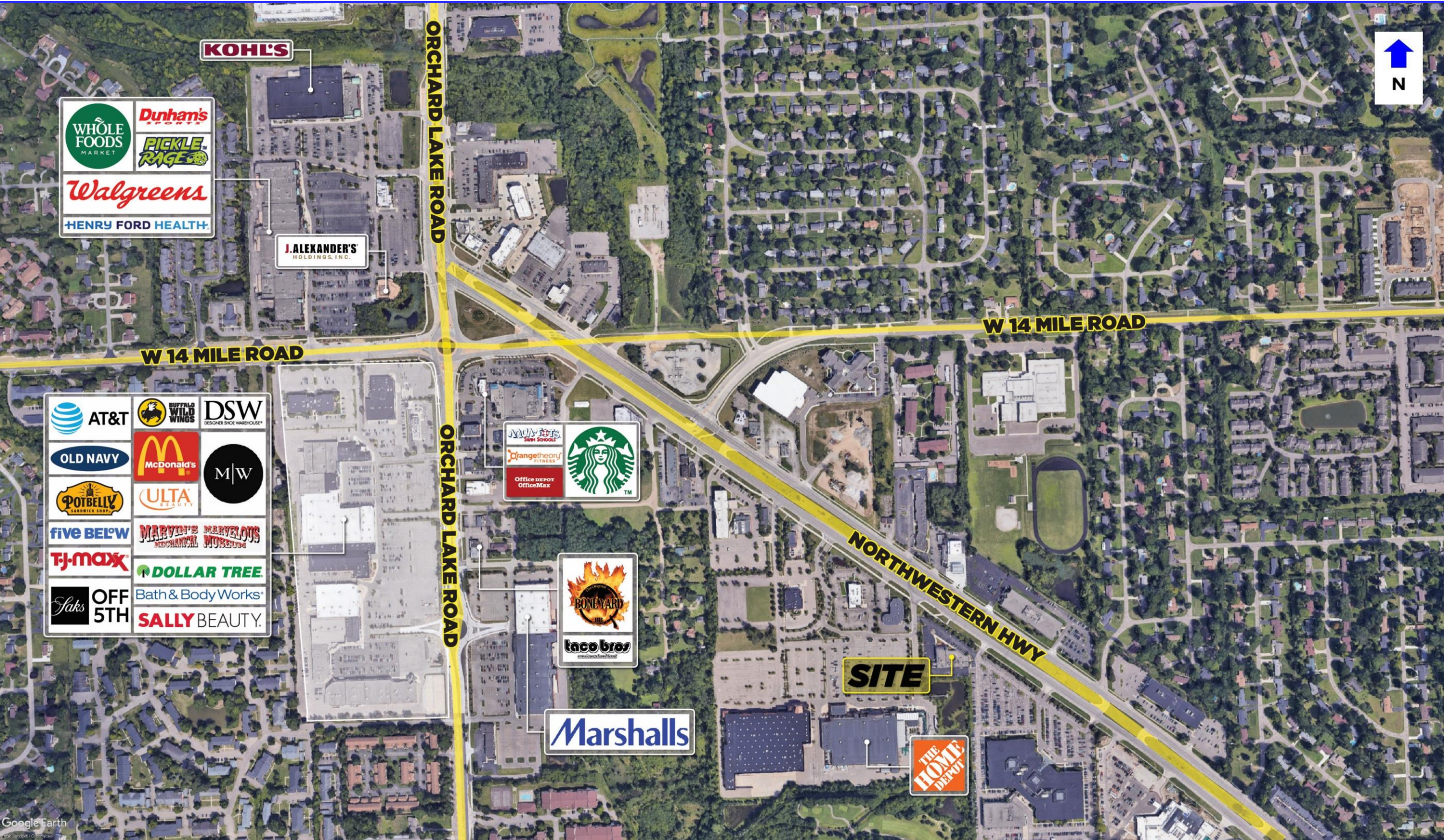

Google Earth

POPULATION	1 MILE	3 MILE	5 MILE
2010 Population	29,376	161,497	782,493
2023 Population	30,253	168,029	806,691
2028 Population Projection	30,370	168,969	812,363
Annual Growth 2010-2022	0.20%	0.30%	0.20%
Annual Growth 2022-2027	0.10%	0.10%	0.10%
Median Age	46	44.4	42.2
Bachelor's Degree or Higher	57%	57%	44%

POPULATION BY RACE	1 MILE	3 MILE	5 MILE
White	20,636	106,429	520,589
Black	5,323	35,838	198,021
American Indian/Alaskan Native	47	315	2,299
Asian	3,478	21,356	66,281
Hawaiian & Pacific Islander	6	47	194
Two or More Races	763	4,044	19,307
Hispanic Origin	661	3,799	31,966

HOUSEHOLDS	1 MILE	3 MILE	5 MILE
2010 Households	12,090	66,812	320,810
2023 Households	12,524	69,919	331,963
2028 Household Projection	12,586	70,391	334,538
Owner Occupied Households	8,866	46,612	229,613
Renter Occupied Households	3,719	23,779	104,924
<b>Avg Household Income</b>	<b>121,285</b>	<b>117,739</b>	<b>104,516</b>
<b>Median Household Income</b>	<b>97,770</b>	<b>89,420</b>	<b>77,644</b>

INCOME	1 MILE	3 MILE	5 MILE
\$25,000 - 50,000	1,421	10,637	59,615
\$50,000 - 75,000	1,824	10,184	53,964
\$75,000 - 100,000	1,391	8,420	41,586
\$100,000 - 125,000	1,297	7,533	36,002
\$125,000 - 150,000	1,274	4,971	23,076
\$150,000 - 200,000	1,668	7,829	29,834
\$200,000+	1,899	11,063	39,883

DAYTIME EMPLOYMENT	ONE MILE			THREE MILE			FIVE MILE		
	TOTAL EMPLOYEES	TOTAL BUSINESSES	EMPLOYEES PER BUSINESS	TOTAL EMPLOYEES	TOTAL BUSINESSES	EMPLOYEES PER BUSINESS	TOTAL EMPLOYEES	TOTAL BUSINESSES	EMPLOYEES PER BUSINESS
<b>Service-Producing Industries</b>	<b>22,603</b>	<b>3,484</b>	<b>6</b>	<b>101,898</b>	<b>11,663</b>	<b>9</b>	<b>414,750</b>	<b>47,230</b>	<b>9</b>
Trade Transportation & Utilities	2,244	278	8	13,094	1,014	13	67,893	5,684	12
Information	930	45	21	6,476	225	29	15,601	935	17
Financial Activities	3,797	479	8	16,292	1,502	11	48,862	5,536	9
Professional & Business Services	4,959	731	7	19,947	2,260	9	73,934	7,906	9
Education & Health Services	6,860	1,512	5	27,740	5,061	5	115,622	19,629	6
Leisure & Hospitality	2,083	192	11	8,490	675	13	44,711	3,018	15
Other Services	1,678	240	7	7,520	848	9	27,204	4,008	7
Public Administration	52	7	7	2,339	78	30	20,923	514	41
<b>Goods-Producing Industries</b>	<b>677</b>	<b>133</b>	<b>5</b>	<b>9,890</b>	<b>593</b>	<b>17</b>	<b>49,005</b>	<b>3,263</b>	<b>15</b>
Natural Resources & Mining	13	5	3	46	17	3	225	58	4
Construction	430	94	5	2,884	358	8	14,683	1,888	8
Manufacturing	234	34	7	6,960	218	32	34,097	1,317	26
<b>Total</b>	<b>23,280</b>	<b>3,617</b>	<b>6</b>	<b>111,788</b>	<b>12,256</b>	<b>9</b>	<b>463,755</b>	<b>50,493</b>	<b>9</b>

**EXCLUSIVELY LISTED BY:**

**LANCE NUMAN**  
ASSOCIATE

[lnuman@cmprealestategroup.com](mailto:lnuman@cmprealestategroup.com)

**CHRIS JONNA**  
PRESIDENT

[cjonna@cmprealestategroup.com](mailto:cjonna@cmprealestategroup.com)

**CONTACT US:**



6476 Orchard Lake Road, Suite A  
West Bloomfield, Michigan 48322



(P): 248.538.2000  
(F): 248.538.9905



Email: [info@cmprealestategroup.com](mailto:info@cmprealestategroup.com)  
Website: [www.cmprealestategroup.com](http://www.cmprealestategroup.com)

The information contained in this Marketing Package does not purport to provide a complete or fully accurate summary of the Property or any of the documents related thereto, nor does it purport to all inclusive or to contain all the information, which a potential tenant may need or desire. All information contained herein has been secured by sources we believe to be reliable; however, CMP Real Estate Group, LLC (“Broker”) has not independently verified any of the information. This Marketing Package prepared by Broker, does not constitute an indication that there has been no change in the Property or the market conditions since the date of preparation of the information herein. Additional information and an opportunity to inspect the Property will be made available to the interested and qualified prospective tenant/purchaser, if available.

Neither Owner nor Broker nor any of there respective officers, Agents or principals has made or will make any representations or warranties, express or implied, as to the accuracy or completeness of this Marketing Package or any of its contents, and no legal commitment or obligation shall arise by reason of the Marketing Package or its contents. Analysis and verification of the information contained in the Marketing Package is solely the responsibility of the prospective tenant/purchaser.

Owner and Broker expressly reserve the right, at their sole discretion, to reject any or all expressions of interest or offers to lease/purchase the Property and/or terminate discussions with any entity at anytime with or without notice. Owner has no legal commitment or obligation to any entity reviewing this Marketing Package or making an offer to lease/purchase the Property unless and until such lease/sale of the Property is approved by Owner in its sole discretion, a written agreement for lease/purchase of the Property unless and until such sale of the Property is approved by Owner in its sole discretion, a written agreement for leased/purchase of the Property has been fully delivered, and approve by Owner, its legal counsel and any conditions to the Owner’s obligations thereunder have been satisfied or waived.



**RETAIL LEASING**  
*Landlord Representation  
& New Project Leasing*



**TENANT REPRESENTATION**  
*Site Selection &  
Negotiations*



**INVESTMENT SALES**  
*STNL & Multi-Tenant, Multi-  
Family, Carwashes, etc.*



**ACQUISITIONS/DISPOSITIONS**  
*Single & Full Portfolio  
Transactions*



**MARKET ANALYSIS**  
*Market Research  
& Site Evaluations*



**NATIONAL RELATIONSHIPS**  
*Retailers & Investors  
across the U.S.*



**TEAMWORK**  
*Innovative  
Solutions*



**SHARED DATABASE**  
*Retailers & Investors  
across the U.S.*