

**FOR LEASE**

**PINE COVE PLAZA | COMMERCE, MICHIGAN**



**NOAH THOMAS**  
ASSOCIATE

[nthomas@cmprealestategroup.com](mailto:nthomas@cmprealestategroup.com)

**ERIK ELWELL**  
ASSOCIATE

[eelwell@cmprealestategroup.com](mailto:eelwell@cmprealestategroup.com)

**CHRIS JONNA**  
PRESIDENT

[cjonna@cmprealestategroup.com](mailto:cjonna@cmprealestategroup.com)



6476 Orchard Lake Road | Suite A | West Bloomfield | Michigan | 48322

Phone: 248.538.2000 | [www.cmprealestategroup.com](http://www.cmprealestategroup.com)

**PROPERTY INFORMATION**

Property Address	8350 Richardson Road
City/Township	Commerce
Shopping Center Size	27,711 SF
Space Available	12,866 SF
Minimum Available	1,373 SF
Maximum Available	6,099 SF
Asking Rental Rate	Contact Broker
Estimated NNN's	\$5.20 PSF
Parking	125 Spaces

**DEMOGRAPHICS (FIVE-MILE RADIUS)**

 <b>POPULATION</b> 151,799 PEOPLE	 <b>MEDIAN AGE</b> 42.7 YEARS OLD
 <b>HOUSEHOLDS</b> 59,634	 <b>CONSUMER SPENDING</b> \$2.2 BILLION ANNUALLY
 <b>AVG HOUSEHOLD INCOME</b> \$113,412/ANNUALLY	 <b>DAYTIME EMPLOYEES</b> 41,210 EMPLOYEES

**JOIN**



**AREA TENANTS & EMPLOYERS**



**PROPERTY HIGHLIGHTS**

- Join Einstein Bagels, Real Estate One and Vital Massage at Pine Cove Plaza.
- Second Generation Restaurant suite available for lease with FF&E.
- Center has great accessibility from both Richardson and Union Lake Roads.
- Strong demographics with over 49,000 residents and average household income in excess of \$124,000 withing a three-mile radius.
- The M-5 Connector connects to Richardson Road through Martin Parkway.

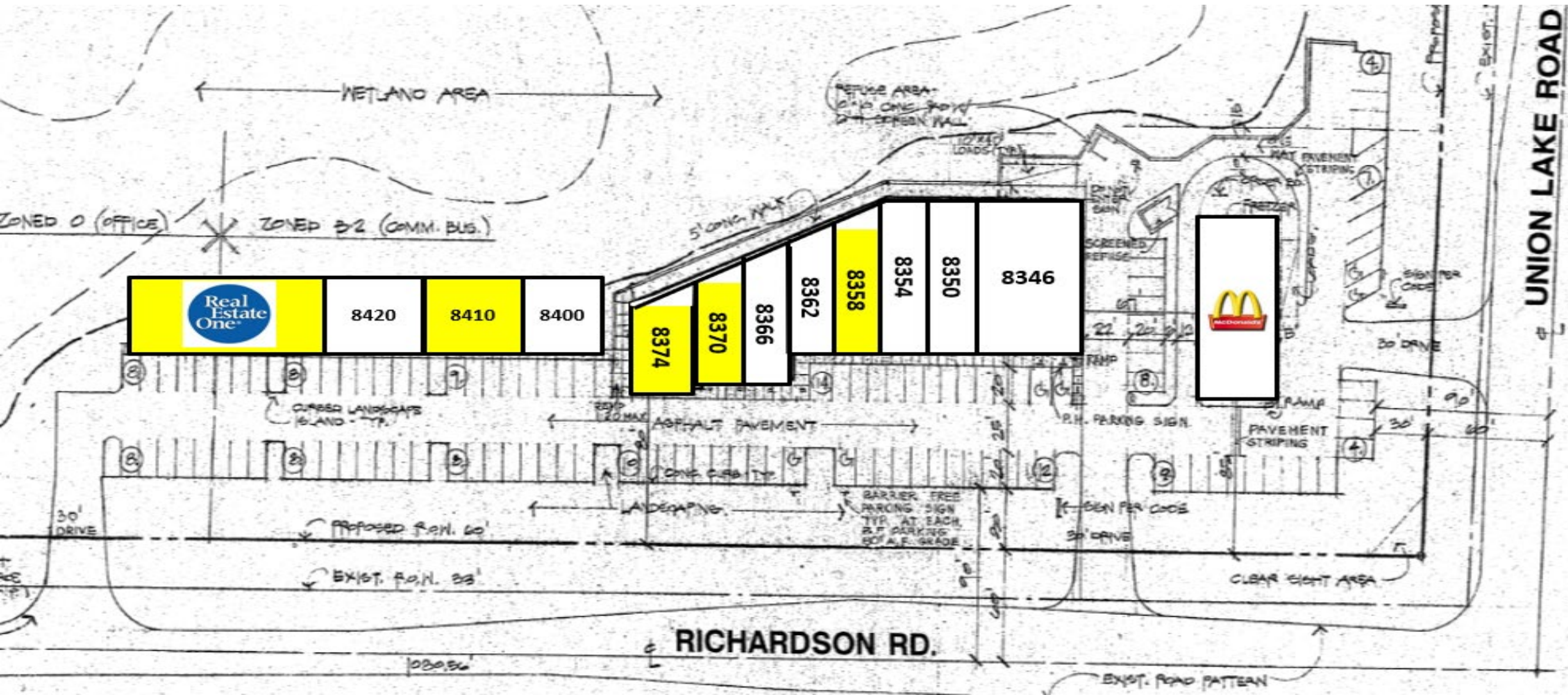

- 8430: Real Estate One- Available (6,099 SF)**
- 8420: Vital Massage (1,421 SF)**
- 8410: Vacant (1,566 SF)**
- 8400: Pita Way (1,140 SF)**
- 8374: Coney Island - Available (2,373 SF)**
- 8370: Vacant – Available (1,373 SF)**

- 8366: Einstein Bagels (1,875 SF)**
- 8362: Dentist Office (1,815 SF)**
- 8358: Hair Salon - Available (1,455 SF)**
- 8354: Dry Cleaners (1,950 SF)**
- 8350: Triumph Physical Therapy (2,500 SF)**
- 8346: Winton Design Center (4,000 SF - Divisible)**





POPULATION	1 MILE	3 MILE	5 MILE
2020 Population	3,967	49,872	150,724
2024 Population	3,924	49,603	149,325
2029 Population Projection	3,889	49,218	148,048
Annual Growth 2020-2024	-0.3%	-0.1%	-0.2%
Annual Growth 2024-2029	-0.2%	-0.2%	-0.2%
Median Age	43.5	45	44.7
Bachelor's Degree or Higher	47%	45%	47%

HOUSEHOLDS	1 MILE	3 MILE	5 MILE
2020 Households	1,462	19,441	61,022
2024 Households	1,447	19,347	60,630
2029 Household Projection	1,434	19,196	60,140
Owner Occupied Households	1,314	15,852	45,171
Renter Occupied Households	120	3,344	14,969
<b>Avg Household Income</b>	<b>\$133,703</b>	<b>\$124,955</b>	<b>\$121,847</b>
<b>Median Household Income</b>	<b>\$110,843</b>	<b>\$102,393</b>	<b>\$95,690</b>

POPULATION BY RACE	1 MILE	3 MILE	5 MILE
White	3,404	40,920	115,917
Black	73	2,838	11,595
American Indian/Alaskan Native	3	50	164
Asian	114	1,964	10,267
Hawaiian & Pacific Islander	0	26	65
Two or More Races	329	3,803	11,318
Hispanic Origin	108	1,478	5,237

INCOME	1 MILE	3 MILE	5 MILE
\$25,000 - 50,000	165	2,554	8,627
\$50,000 - 75,000	181	2,879	9,094
\$75,000 - 100,000	190	2,167	7,746
\$100,000 - 125,000	166	2,283	6,579
\$125,000 - 150,000	148	2,026	5,597
\$150,000 - 200,000	231	2,524	7,319
\$200,000+	250	3,0559	9,485

DAYTIME EMPLOYMENT	ONE MILE			THREE MILE			FIVE MILE		
	TOTAL EMPLOYEES	TOTAL BUSINESSES	EMPLOYEES PER BUSINESS	TOTAL EMPLOYEES	TOTAL BUSINESSES	EMPLOYEES PER BUSINESS	TOTAL EMPLOYEES	TOTAL BUSINESSES	EMPLOYEES PER BUSINESS
<b>Service-Producing Industries</b>	<b>3,866</b>	<b>457</b>	<b>8</b>	<b>14,576</b>	<b>2,077</b>	<b>7</b>	<b>36,437</b>	<b>4,857</b>	<b>8</b>
Trade Transportation & Utilities	603	84	7	2,212	279	8	5,676	555	10
Information	133	12	11	473	37	13	1,116	82	14
Financial Activities	280	48	6	1,171	243	5	2,762	496	6
Professional & Business Services	1,058	85	12	2,014	289	7	4,711	683	7
Education & Health Services	590	120	5	4,931	814	6	14,153	2,140	7
Leisure & Hospitality	588	37	16	2,107	163	13	4,187	350	12
Other Services	524	63	8	1,383	230	6	3,135	509	6
Public Administration	90	8	11	285	22	13	697	42	17
<b>Goods-Producing Industries</b>	<b>804</b>	<b>70</b>	<b>11</b>	<b>2,565</b>	<b>215</b>	<b>12</b>	<b>5,641</b>	<b>457</b>	<b>12</b>
Natural Resources & Mining	24	1	24	33	4	8	64	14	5
Construction	279	32	9	684	139	5	1,626	301	5
Manufacturing	501	37	14	1,848	72	26	3,951	142	28
<b>Total</b>	<b>4,670</b>	<b>527</b>	<b>9</b>	<b>17,141</b>	<b>2,292</b>	<b>7</b>	<b>42,078</b>	<b>5,314</b>	<b>8</b>

## EXCLUSIVELY LISTED BY:

**NOAH THOMAS**  
ASSOCIATE

[nthomas@cmprealestategroup.com](mailto:nthomas@cmprealestategroup.com)

**ERIK ELWELL**  
ASSOCIATE

[eelwell@cmprealestategroup.com](mailto:eelwell@cmprealestategroup.com)

**CHRIS JONNA**  
PRESIDENT

[cjonna@cmprealestategroup.com](mailto:cjonna@cmprealestategroup.com)

## CONTACT US:



6476 Orchard Lake Road, Suite A  
West Bloomfield, Michigan 48322



(P): 248.538.2000  
(F): 248.538.9905



Email: [info@cmprealestategroup.com](mailto:info@cmprealestategroup.com)  
Website: [www.cmprealestategroup.com](http://www.cmprealestategroup.com)

The information contained in this Marketing Package does not purport to provide a complete or fully accurate summary of the Property or any of the documents related thereto, nor does it purport to all inclusive or to contain all the information, which a potential tenant may need or desire. All information contained herein has been secured by sources we believe to be reliable; however, CMP Real Estate Group, LLC (“Broker”) has not independently verified any of the information. This Marketing Package prepared by Broker, does not constitute an indication that there has been no change in the Property or the market conditions since the date of preparation of the information herein. Additional information and an opportunity to inspect the Property will be made available to the interested and qualified prospective tenant/purchaser, if available.

Neither Owner nor Broker nor any of there respective officers, Agents or principals has made or will make any representations or warranties, express or implied, as to the accuracy or completeness of this Marketing Package or any of its contents, and no legal commitment or obligation shall arise by reason of the Marketing Package or its contents. Analysis and verification of the information contained in the Marketing Package is solely the responsibility of the prospective tenant/purchaser.

Owner and Broker expressly reserve the right, at their sole discretion, to reject any or all expressions of interest or offers to lease/purchase the Property and/or terminate discussions with any entity at anytime with or without notice. Owner has no legal commitment or obligation to any entity reviewing this Marketing Package or making an offer to lease/purchase the Property unless and until such lease/sale of the Property is approved by Owner in its sole discretion, a written agreement for lease/purchase of the Property unless and until such sale of the Property is approved by Owner in its sole discretion, a written agreement for leased/purchase of the Property has been fully delivered, and approve by Owner, its legal counsel and any conditions to the Owner’s obligations thereunder have been satisfied or waived.



**RETAIL LEASING**  
*Landlord Representation  
& New Project Leasing*



**TENANT REPRESENTATION**  
*Site Selection &  
Negotiations*



**INVESTMENT SALES**  
*STNL & Multi-Tenant, Multi-  
Family, Carwashes, etc.*



**ACQUISITIONS/DISPOSITIONS**  
*Single & Full Portfolio  
Transactions*



**MARKET ANALYSIS**  
*Market Research  
& Site Evaluations*



**NATIONAL RELATIONSHIPS**  
*Retailers & Investors  
across the U.S.*



**TEAMWORK**  
*Innovative  
Solutions*



**SHARED DATABASE**  
*Retailers & Investors  
across the U.S.*