

**FOR LEASE**

**27100 LAHSER ROAD | SOUTHFIELD, MICHIGAN**



**ERIK ELWELL**  
ASSOCIATE

**ANTHONY SESI**  
VICE PRESIDENT

[eelwell@cmprealestategroup.com](mailto:eelwell@cmprealestategroup.com)

[asesi@cmprealestategroup.com](mailto:asesi@cmprealestategroup.com)

6476 Orchard Lake Road | Suite A | West Bloomfield | Michigan | 48322

Phone: 248.538.2000 | [www.cmprealestategroup.com](http://www.cmprealestategroup.com)

**PROPERTY INFORMATION**

Property Address	27100 Lahser Road
City/Township	Southfield
Building Size	4,775 SF
Land Size	0.94 AC
Space Available	4,775 SF
Lease Rate	Contact Broker
Estimated NNN's	TBD

**DEMOGRAPHICS (FIVE-MILE RADIUS)**

 <b>POPULATION</b> 267,822 PEOPLE	 <b>MEDIAN AGE</b> 42 YEARS OLD
 <b>HOUSEHOLDS</b> 113,781	 <b>CONSUMER SPENDING</b> \$3.3 BILLION ANNUALLY
 <b>AVG HOUSEHOLD INCOME</b> \$97,685/ANNUALLY	 <b>DAYTIME POPULATION</b> 165,203 PEOPLE

**AREA TENANTS & EMPLOYERS**



**PROPERTY HIGHLIGHTS**

- Former Bank Branch for Lease in Southfield, MI, suitable for medical or retail use with drive-thru capability.
- Prime location off the Lahser exit of I-696 with 150,000+ VPD (vehicles per day).
- Strong demographics: Over 75,000 residents within a 3-mile radius, with an average household income exceeding \$94,000
- Major capital improvements scheduled for Q1 2025, including a refaced building.



RETAIL



MEDICAL



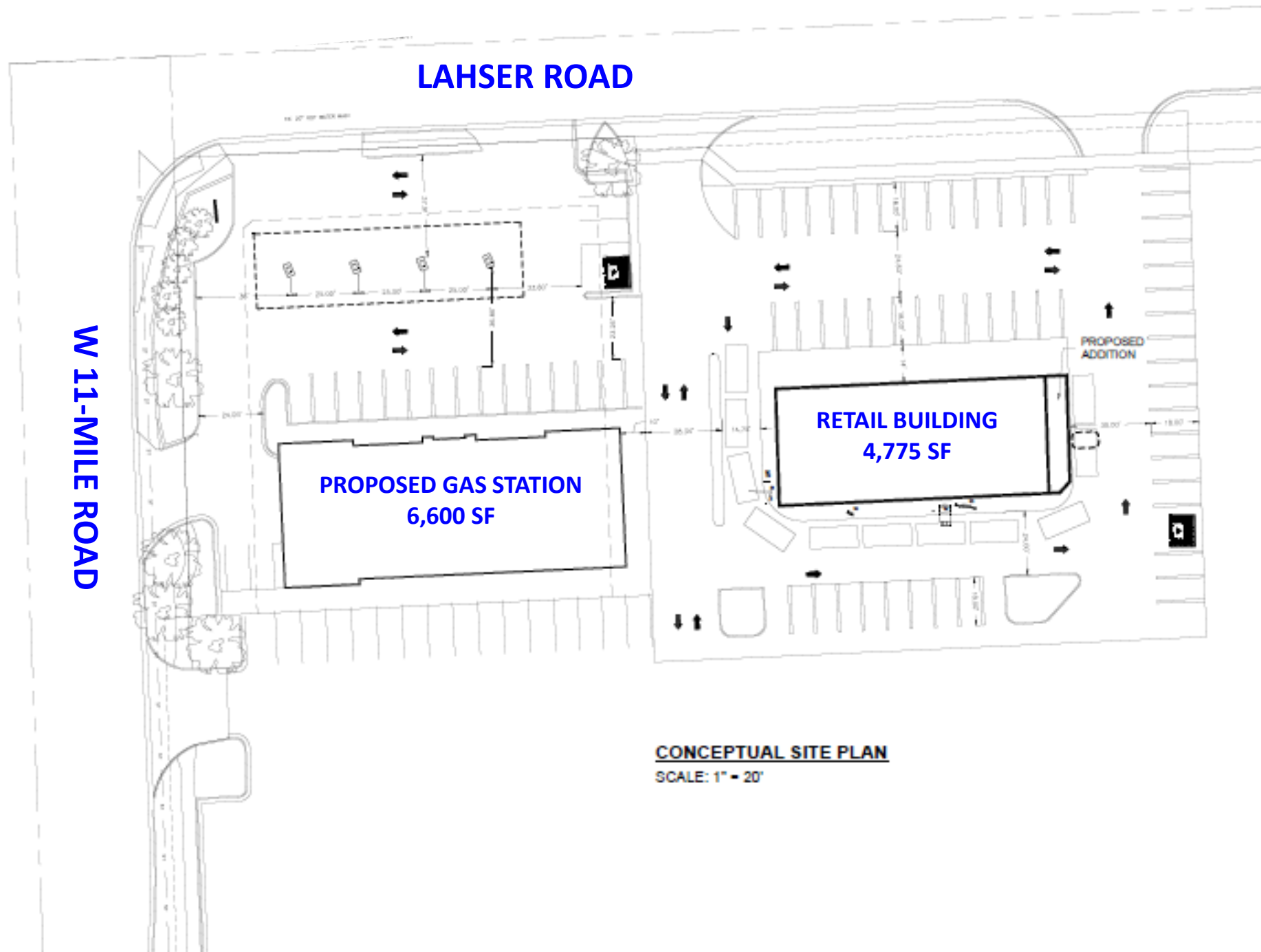

**LAHSER ROAD**

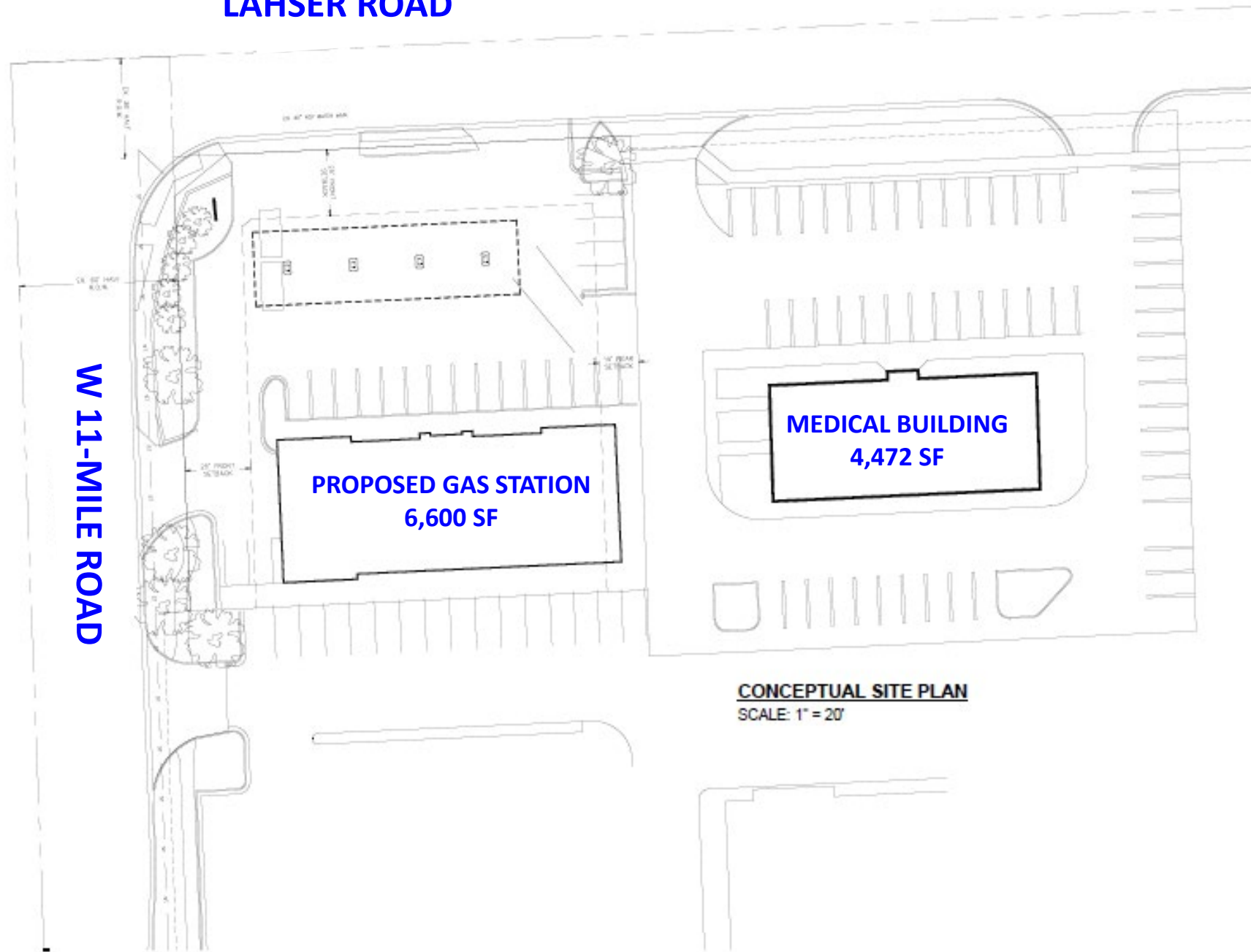







POPULATION	1 MILE	3 MILE	5 MILE
2020 Population	9,924	75,366	267,822
2024 Population	9,661	73,391	262,262
2029 Population Projection	9,544	72,510	258,685
Annual Growth 2020-2024	-0.7%	-0.7%	-0.5%
Annual Growth 2024-2029	-0.2%	-0.2%	-0.3%
Median Age	45.7	44.9	42
Bachelor's Degree or Higher	47%	43%	41%

HOUSEHOLDS	1 MILE	3 MILE	5 MILE
2020 Households	4,456	33,204	113,781
2024 Households	4,377	32,363	111,509
2029 Household Projection	4,331	31,978	110,015
Owner Occupied Households	2,074	18,079	67,971
Renter Occupied Households	2,257	13,898	42,044
<b>Avg Household Income</b>	<b>\$99,218</b>	<b>\$94,088</b>	<b>\$97,685</b>
<b>Median Household Income</b>	<b>\$73,212</b>	<b>\$68,982</b>	<b>\$69,474</b>

POPULATION BY RACE	1 MILE	3 MILE	5 MILE
White	1,663	21,319	115,835
Black	7,377	45,038	120,050
American Indian/Alaskan Native	9	94	368
Asian	162	2,062	7,710
Hawaiian & Pacific Islander	3	53	122
Two or More Races	446	4,824	18,177
Hispanic Origin	103	1,742	6,594

INCOME	1 MILE	3 MILE	5 MILE
\$25,000 - 50,000	1,102	6,049	21,421
\$50,000 - 75,000	614	5,947	17,859
\$75,000 - 100,000	472	3,974	13,264
\$100,000 - 125,000	447	3,425	10,973
\$125,000 - 150,000	316	1,948	6,513
\$150,000 - 200,000	536	2,578	8,839
\$200,000+	381	2,980	12,527

DAYTIME EMPLOYMENT	ONE MILE			THREE MILE			FIVE MILE		
	TOTAL EMPLOYEES	TOTAL BUSINESSES	EMPLOYEES PER BUSINESS	TOTAL EMPLOYEES	TOTAL BUSINESSES	EMPLOYEES PER BUSINESS	TOTAL EMPLOYEES	TOTAL BUSINESSES	EMPLOYEES PER BUSINESS
<b>Service-Producing Industries</b>	<b>11,642</b>	<b>1,076</b>	<b>11</b>	<b>67,828</b>	<b>7,323</b>	<b>9</b>	<b>152,546</b>	<b>20,873</b>	<b>7</b>
Trade Transportation & Utilities	843	57	15	8,305	554	15	17,708	1,888	9
Information	382	23	17	3,854	165	23	5,581	336	17
Financial Activities	1,984	179	11	10,770	955	11	20,960	2,284	9
Professional & Business Services	3,007	283	11	17,006	1,656	10	28,361	3,449	8
Education & Health Services	4,366	382	11	16,877	2,903	6	50,672	9,843	5
Leisure & Hospitality	436	34	13	4,870	338	14	13,763	990	14
Other Services	619	117	5	4,528	691	7	11,320	1,912	6
Public Administration	5	1	5	1,618	61	27	4,181	171	24
<b>Goods-Producing Industries</b>	<b>970</b>	<b>51</b>	<b>19</b>	<b>7,957</b>	<b>350</b>	<b>23</b>	<b>12,657</b>	<b>959</b>	<b>13</b>
Natural Resources & Mining	2	1	2	25	9	3	81	20	4
Construction	206	24	9	1,714	184	9	4,221	567	7
Manufacturing	762	26	29	6,218	157	40	8,355	372	22
<b>Total</b>	<b>12,612</b>	<b>1,127</b>	<b>11</b>	<b>75,785</b>	<b>7,673</b>	<b>10</b>	<b>165,203</b>	<b>21,832</b>	<b>8</b>

## EXCLUSIVELY LISTED BY:

**ERIK ELWELL**  
ASSOCIATE

[eelwell@cmprealestategroup.com](mailto:eelwell@cmprealestategroup.com)

**ANTHONY SESI**  
VICE PRESIDENT

[asesi@cmprealestategroup.com](mailto:asesi@cmprealestategroup.com)

## CONTACT US:



6476 Orchard Lake Road, Suite A  
West Bloomfield, Michigan 48322



(P): 248.538.2000  
(F): 248.538.9905



Email: [info@cmprealestategroup.com](mailto:info@cmprealestategroup.com)  
Website: [www.cmprealestategroup.com](http://www.cmprealestategroup.com)

The information contained in this Marketing Package does not purport to provide a complete or fully accurate summary of the Property or any of the documents related thereto, nor does it purport to all inclusive or to contain all the information, which a potential tenant may need or desire. All information contained herein has been secured by sources we believe to be reliable; however, CMP Real Estate Group, LLC (“Broker”) has not independently verified any of the information. This Marketing Package prepared by Broker, does not constitute an indication that there has been no change in the Property or the market conditions since the date of preparation of the information herein. Additional information and an opportunity to inspect the Property will be made available to the interested and qualified prospective tenant/purchaser, if available.

Neither Owner nor Broker nor any of there respective officers, Agents or principals has made or will make any representations or warranties, express or implied, as to the accuracy or completeness of this Marketing Package or any of its contents, and no legal commitment or obligation shall arise by reason of the Marketing Package or its contents. Analysis and verification of the information contained in the Marketing Package is solely the responsibility of the prospective tenant/purchaser.

Owner and Broker expressly reserve the right, at their sole discretion, to reject any or all expressions of interest or offers to lease/purchase the Property and/or terminate discussions with any entity at anytime with or without notice. Owner has no legal commitment or obligation to any entity reviewing this Marketing Package or making an offer to lease/purchase the Property unless and until such lease/sale of the Property is approved by Owner in its sole discretion, a written agreement for lease/purchase of the Property unless and until such sale of the Property is approved by Owner in its sole discretion, a written agreement for leased/purchase of the Property has been fully delivered, and approve by Owner, its legal counsel and any conditions to the Owner’s obligations thereunder have been satisfied or waived.



**RETAIL LEASING**  
*Landlord Representation  
& New Project Leasing*



**TENANT REPRESENTATION**  
*Site Selection &  
Negotiations*



**INVESTMENT SALES**  
*STNL & Multi-Tenant, Multi-  
Family, Carwashes, etc.*



**ACQUISITIONS/DISPOSITIONS**  
*Single & Full Portfolio  
Transactions*



**MARKET ANALYSIS**  
*Market Research  
& Site Evaluations*



**NATIONAL RELATIONSHIPS**  
*Retailers & Investors  
across the U.S.*



**TEAMWORK**  
*Innovative  
Solutions*



**SHARED DATABASE**  
*Retailers & Investors  
across the U.S.*